



COMPRESSORES STANDARD

*STANDARD
COMPRESSORS*



COMPRESSOR



COMPRESSOR SD5H09 (EX SD505)

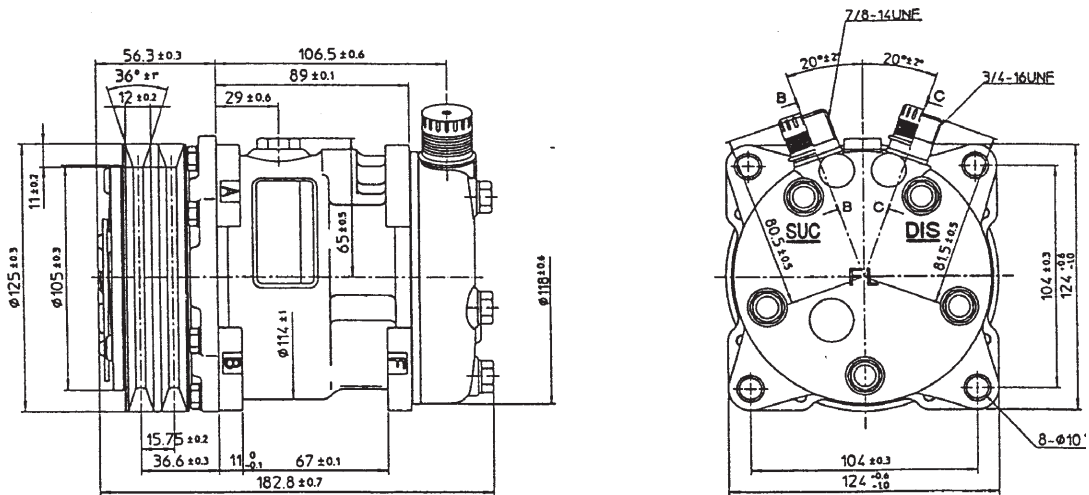

COMPRESSORE SD5H09 12 Volt

Codigo GrupoVei Code	Frizione Clutch	Gole Groove	Linea G.Line	Attacchi Fittings	Misura Size	Testata Head	Cod. Sanden Code
C.88.07.223.A	Ø125 (5")	A2	36.6	V	CONO / FLARE	E	/
C.88.07.224.A	Ø125 (5")	A2	36.6	V	O.RING 7/8" - 3/4"	FL	SD5072
C.88.07.216.A	Ø125 (5")	A2	36.6	V	ROTOLOCK 1"	C	SD5076
C.88.07.226.A	Ø125 (5")	A2	36.6	O	ROTOLOCK 1"	M	/
C.88.07.313.A	Ø125 (5")	A2	36.6	V	ROTOLOCK 1"	C	SD9080

COMPRESSORE SD5H09 24 Volt

C.88.07.302.A	Ø125 (5")	A2	36.6	V	O.RING 7/8" - 3/4"	FL	SD5073
C.88.07.338.A	Ø125 (5")	A2	36.6	V	ROTOLOCK 1"	MC	
C.88.07.503.A	Ø125 (5")	A2	36.6	V	CONO / FLARE		



COMPRESSOR



COMPRESSOR SD5H11 (EX SD507)

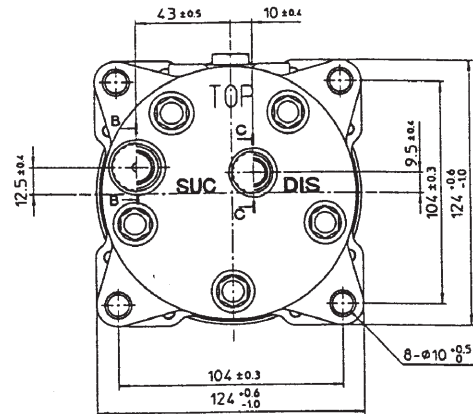
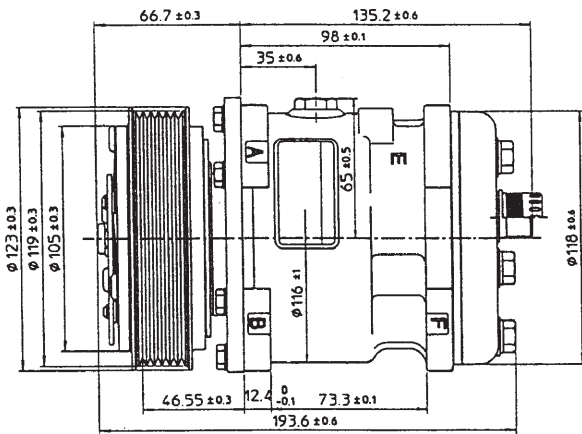
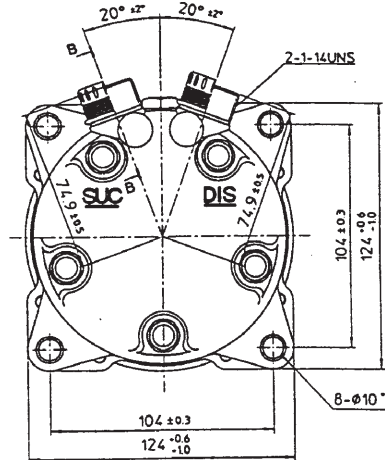
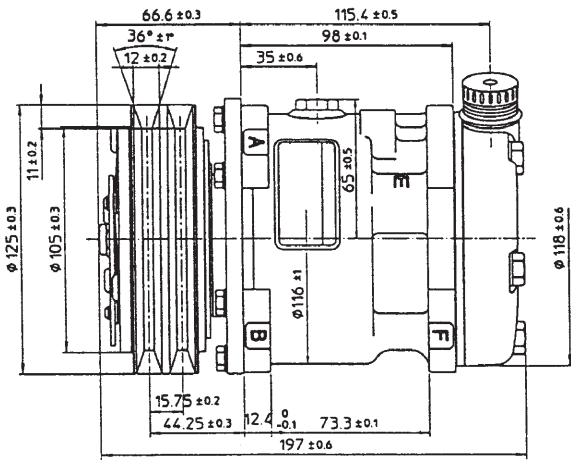

COMPRESSORE SD5H11 12 Volt

Codigo GrupoVei Code	Frizione Clutch	Gole Groove	Linea G.Line	Attacchi Fittings	Misura Size	Testata Head	Cod. Sanden Code
C.88.07.227.A	φ125 (5")	A2	44.25	V	CONO / FLARE	BL	/
C.88.07.228.A	φ125 (5")	A2	44.25	V	O.RING 7/8" - 3/4"	FL	SD6321
C.88.07.229.A	φ125 (5")	A2	44.25	V	ROTOLOCK 1"	C	SD6332
C.88.07.230.A	φ125 (5")	A2	44.25	O	ROTOLOCK 1"	M	/
C.88.07.222.A	φ119 (4"7/8)	PV6	46.55	V	ROTOLOCK 1"		/
C.88.07.221.A	φ119 (4"7/8)	PV6	46.55	V	O.RING 7/8" - 3/4"		SD6323
C.88.07.424.A	φ119 (4"7/8)	PV6	46.55	O	O.RING 7/8" - 3/4"		SD6322
C.88.07.505.A	φ125 (5")	A2	44.25	O	O.RING 7/8" - 3/4"		SD6334

COMPRESSOR SD5H14 (EX SD508/510)

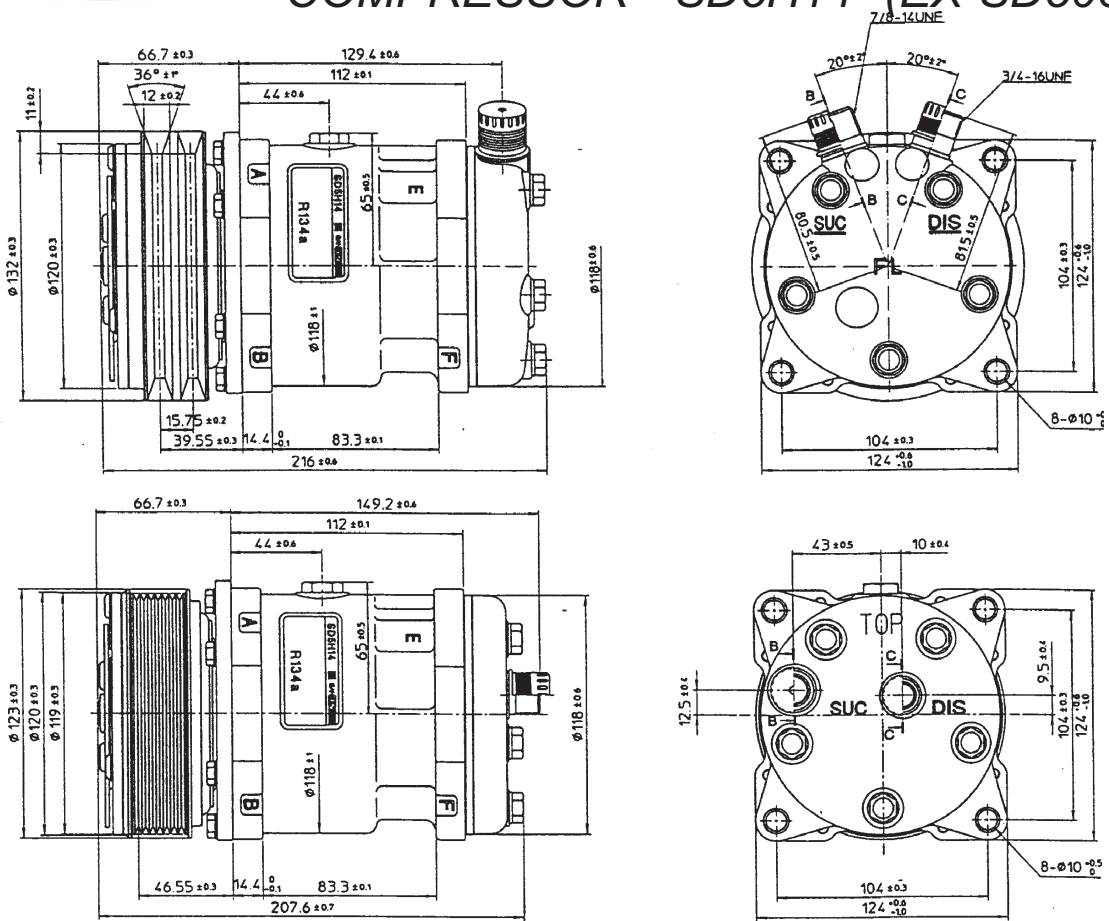

COMPRESSORE SD5H14 12 Volt

Codigo GrupoVei Code	Frizione Clutch	Gole Groove	Linea G.Line	Attacchi Fittings	Misura Size	Testata Head	Cod. Sanden Code
C.88.07.231.A	Ø132 (5"1/4)	A2	39.55	V	CONO / FLARE	E	SD6611
C.88.07.232.A	Ø132 (5"1/4)	A2	39.55	V	ROTOLOCK 1"	C	SD6642
C.88.07.233.A	Ø132 (5"1/4)	A2	39.55	O	ROTOLOCK 1"	M	SD6631
C.88.07.234.A	Ø132 (5"1/4)	A2	39.55	V	O.Ring 7/8" - 3/4"	FL	SD6626
C.88.07.235.A	Ø132 (5"1/4)	A2	39.55	O	O.Ring 7/8" - 3/4"	K	SD6630
C.88.07.236.A	Ø119 (4"7/8)	PV7	46.55	V	ROTOLOCK 1"	C	/
C.88.07.237.A	Ø119 (4"7/8)	PV7	46.55	O	ROTOLOCK 1"	M	/
C.88.07.238.A	Ø119 (4"7/8)	PV7	46.55	V	O.Ring 7/8" - 3/4"	FL	SD6629
C.88.07.239.A	Ø119 (4"7/8)	PV7	46.55	O	O.Ring 7/8" - 3/4"	K	SD6628
C.88.07.275.A	Ø132 (5"1/4)	PV6		O	ROTOLOCK 1"	M	/
C.88.07.225.A	Ø132 (5"1/4)	A2	39.55	V	ROTOLOCK 1"		SD9114 - (510)
C.88.07.307.A	Ø132 (5"1/4)	A2	39.55	V	CONO / FLARE		SD9103 - (510)
C.88.07.483.A	Ø132 (5"1/4)	A2	39.55	O	ROTOLOCK 1"		/ - (510)
C.88.07.484.A	Ø132 (5"1/4)	A2	39.55	O	O.Ring 7/8" - 3/4"		/ - (510)

COMPRESSOR SD5H14 - 24 Volt (EX SD508/510)

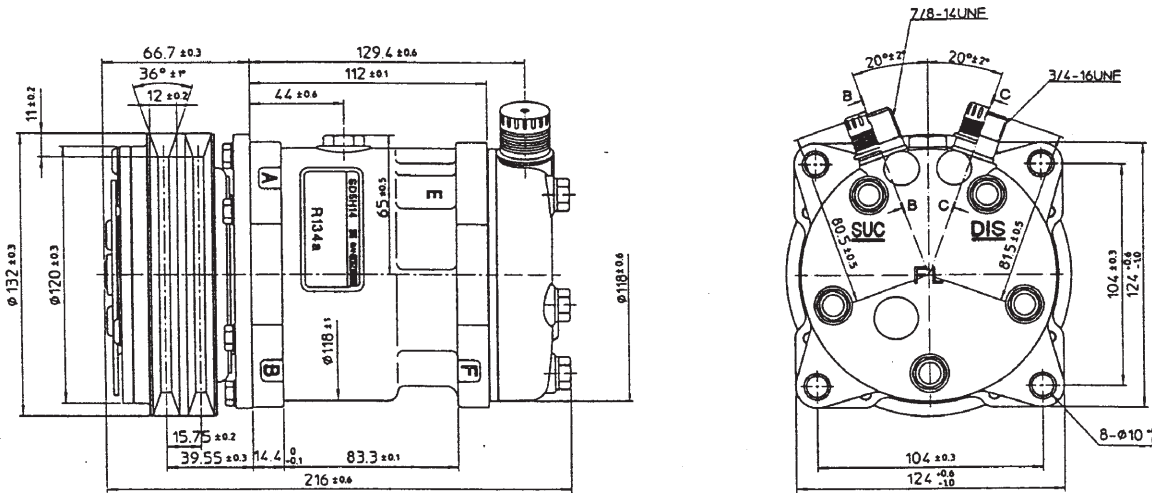

COMPRESSORE SD5H14 24 Volt

Codigo GrupoVei Code	Frizione Clutch	Gole Groove	Linea G.Line	Attacchi Fittings	Misura Size	Testata Head	Cod. Sanden Code
C.88.07.280.A	Ø132 (5"1/4)	A2	39.55	V	CONO / FLARE	E	SD6612
C.88.07.281.A	Ø132 (5"1/4)	A2	39.55	V	ROTOLOCK 1"	C	SD6667
C.88.07.282.A	Ø132 (5"1/4)	A2	39.55	O	ROTOLOCK 1"	M	SD6632
C.88.07.283.A	Ø132 (5"1/4)	A2	39.55	V	O.Ring 7/8" - 3/4"	FL	SD6627
C.88.07.284.A	Ø132 (5"1/4)	A2	39.55	O	O.Ring 7/8" - 3/4"	K	SD6634
C.88.07.240.A	Ø152 (6")	A2			CONO / FLARE	BL	SD6623
C.88.07.406.A	Ø152 (6")	A2		O	ROTOLOCK 1"	M	
C.88.07.493.A		PV10		V	O.Ring 7/8" - 3/4"	E	SD6649
C.88.07.312.A	Ø132 (5"1/4)	A2	39.05	V	CONO / FLARE		SD9105 - (510)
C.88.07.485.A	Ø132 (5"1/4)	A2	39.05	V	ROTOLOCK 1"		- (510)
C.88.07.486.A	Ø132 (5"1/4)	A2	39.05	V	O.Ring 7/8" - 3/4"		- (510)
C.88.07.501.A	Ø152 (6")	A2	39.05	V	O.Ring 7/8" - 3/4"		

COMPRESSOR SD7B10 (EX SDB705)

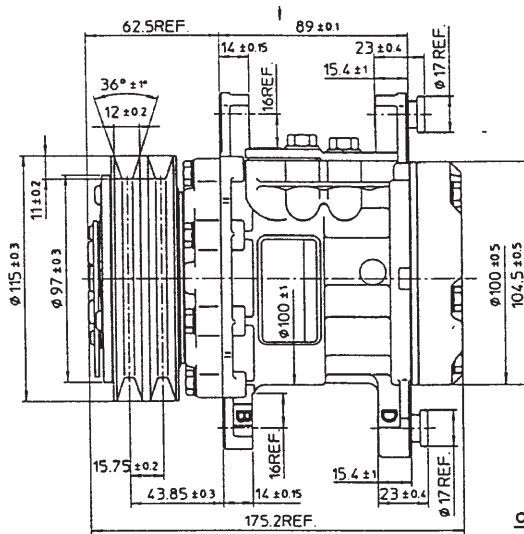

CLUTCH SPECIFICATIONS

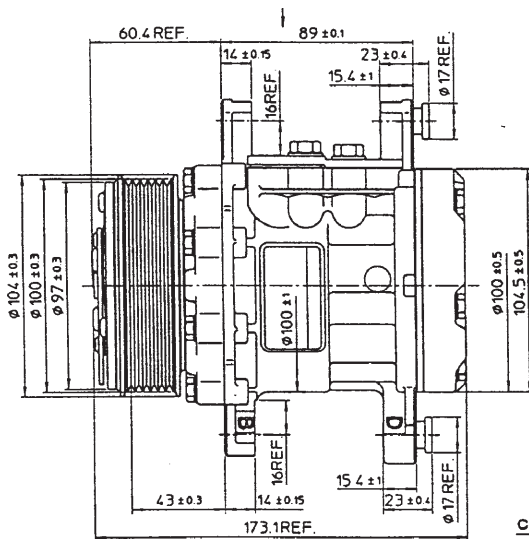
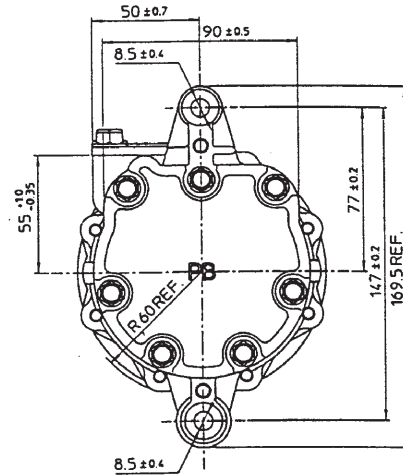

CLUTCH SPECIFICATIONS

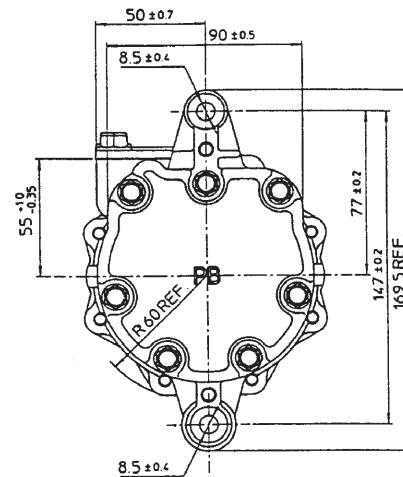

COMPRESSORE SD7B10 12 Volt

Codigo GrupoVei Code	Frizione Clutch	Gole Groove	Linea G.Line	Attacchi Fittings	Misura Size	Testata Head	Cod. Sanden Code
C.88.07.209.A	∅ 115 mm	A2	43.85	V	FLANGIA / B.PAD	PB	SD7170
C.88.07.241.A	∅ 100 mm	PV6	43.00	V	FLANGIA / B.PAD	PB	SD7172
C.88.07.242.A	∅ 112 mm	PV6	40.70	V	FLANGIA / B.PAD	PB	SD7176



COMPRESSOR



COMPRESSOR SD7H13 (EX SD708)

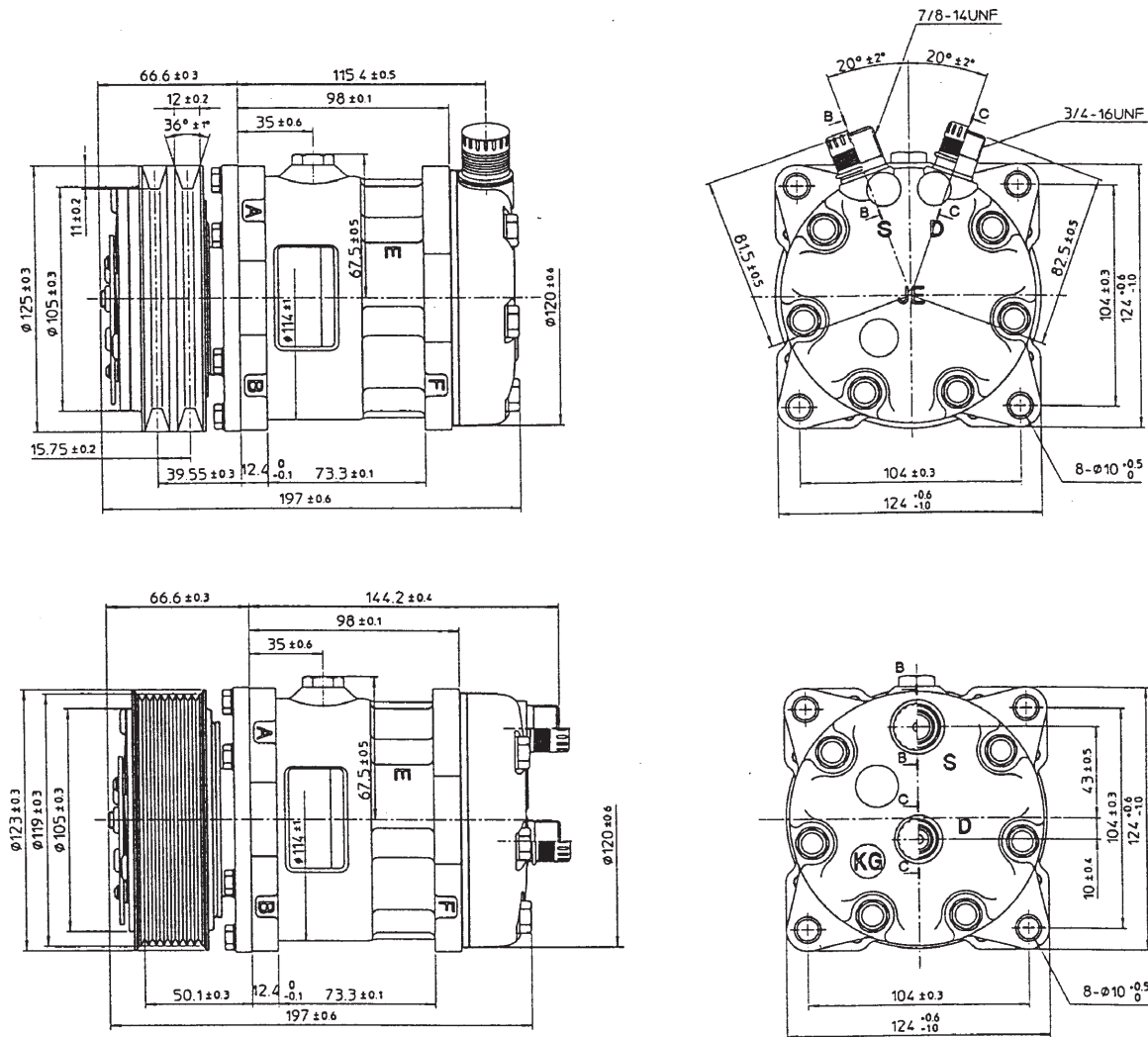

COMPRESSORE SD7H13 12 Volt

Codigo GrupoVei Code	Frizione Clutch	Gole Groove	Linea G.Line	Attacchi Fittings	Misura Size	Testata Head	Cod. Sanden Code
C.88.07.210.A	φ125 (5")	A2	44.25	V	ROTOLOCK 1"	CB	SD7332
C.88.07.244.A	φ125 (5")	A2	44.25	O	ROTOLOCK 1"	MB	/
C.88.07.245.A	φ125 (5")	A2	39.55	V	O.Ring 7/8" - 3/4"	JE	SD7302
C.88.07.246.A	φ125 (5")	A2	39.55	O	O.Ring 7/8" - 3/4"	KG	SD7301
C.88.07.247.A	φ119 (4"7/8)	PV8	50.10	V	ROTOLOCK 1"	CB	/
C.88.07.248.A	φ119 (4"7/8)	PV8	50.10	O	ROTOLOCK 1"	MB	/
C.88.07.249.A	φ119 (4"7/8)	PV8	50.10	V	O.Ring 7/8" - 3/4"	JE	SD7306
C.88.07.250.A	φ119 (4"7/8)	PV8	50.10	O	O.Ring 7/8" - 3/4"	KG	SD7305
C.88.07.322.A	φ119 (4"7/8)	PV8	56.50	V	O.Ring 7/8" - 3/4"	JE	SD7320
C.88.07.467.A	φ125 (5")	A2	39.55	V	O.Ring 7/8" - 3/4"	KG	

COMPRESSOR SD7H15 (EX SD709)

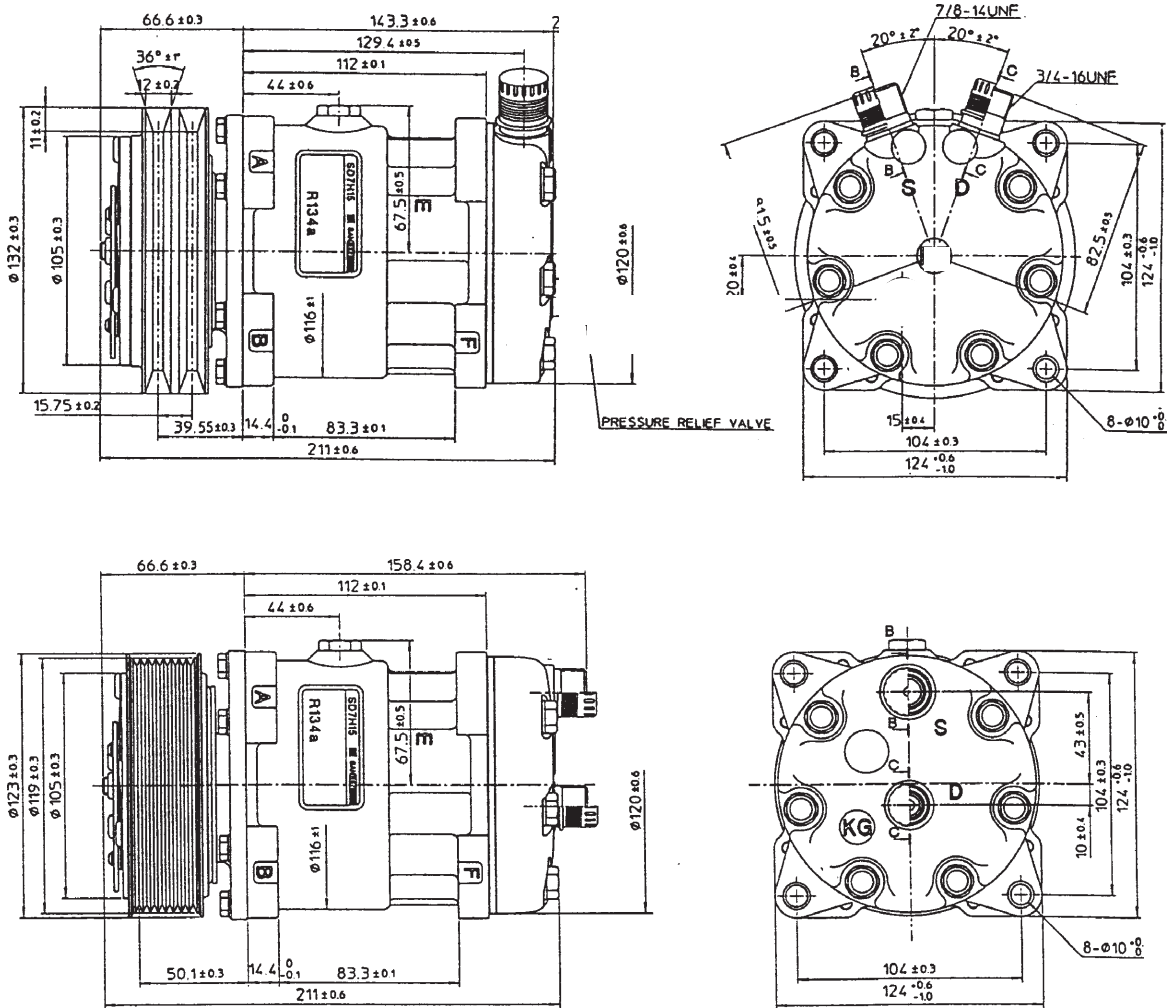

COMPRESSORE SD7H15 12 Volt

Codigo GrupoVei Code	Frizione Clutch	Gole Groove	Linea G.Line	Attacchi Fittings	Misura Size	Testata Head	Cod. Sanden Code
C.88.07.204.A	φ132 (5"1/4)	A2	39.55	V	ROTOLOCK 1"	CB	SD7849
C.88.07.206.A	φ132 (5"1/4)	A2	39.55	O	ROTOLOCK 1"	MB	SD7851
C.88.07.253.A	φ132 (5"1/4)	A2	39.55	V	O.Ring 7/8" - 3/4"	JE	SD7863
C.88.07.254.A	φ132 (5"1/4)	A2	39.55	O	O.Ring 7/8" - 3/4"	KG	SD7862
C.88.07.255.A	φ119 (4"7/8)	PV8	50.10	V	ROTOLOCK 1"	CB	SD7850
C.88.07.256.A	φ119 (4"7/8)	PV8	50.10	O	ROTOLOCK 1"	MB	SD7830
C.88.07.257.A	φ119 (4"7/8)	PV8	50.10	V	O.Ring 7/8" - 3/4"	JE	SD7890
C.88.07.258.A	φ119 (4"7/8)	PV8	50.10	O	O.Ring 7/8" - 3/4"	KG	SD7889
Comp .Autoclima C.88.07.316.A	φ119 (4"7/8)	PV8	46.50	O	ROTOLOCK 1"		SD7822
C.88.07.500.A	φ125 (5")	A2	39.05	O	ROTOLOCK 1"	MD	SD7819

COMPRESSOR SD7H15 - 24 Volt (EX SD709)

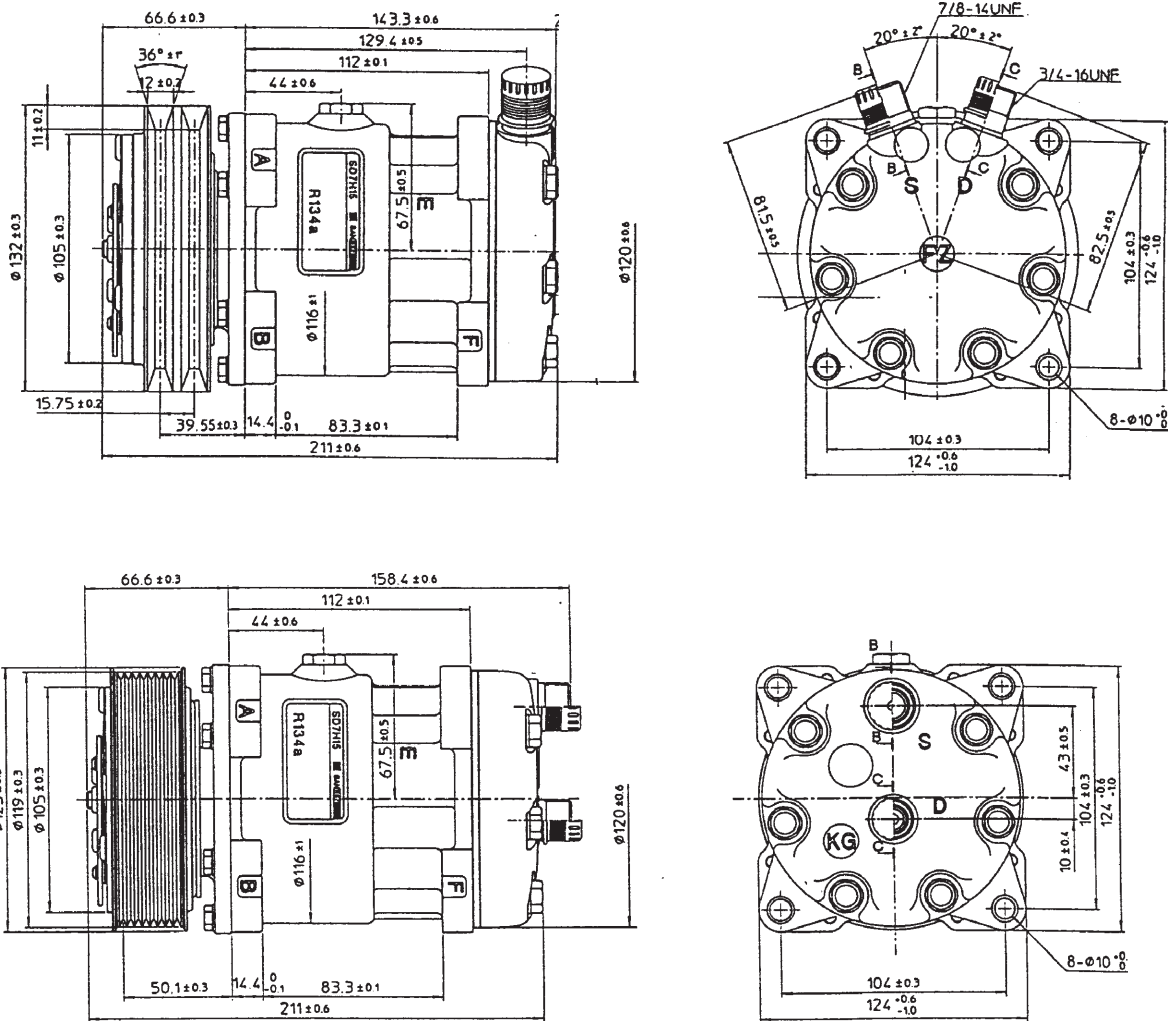

COMPRESSORE SD7H15 24 Volt

Codice GrupoVei Code	Frizione Clutch	Gole Groove	Linea G.Line	Attacchi Fittings	Misura Size	Testata Head	Cod. Sanden Code
C.88.07.285.A	∅132 (5"1/4)	A2	39.55	V	ROTOLOCK 1"	CB	SD7872
C.88.07.286.A	∅132 (5"1/4)	A2	39.55	O	ROTOLOCK 1"	MB	SD7871
C.88.07.287.A	∅132 (5"1/4)	A2	39.55	V	O.Ring 7/8" - 3/4"	JE	/
C.88.07.288.A	∅132 (5"1/4)	A2	39.55	O	O.Ring 7/8" - 3/4"	KG	/
C.88.07.497.A	∅152 (6")	PV8		O	ROTOLOCK 1"		SD4795
C.88.07.510.A	∅132 (5"1/4)	A2	39.55	O	ROTOLOCK 1"		SD8145
C.88.07.519.A	∅119 (4"7/8)	PV8		O	ROTOLOCK 1"		

SCROLL

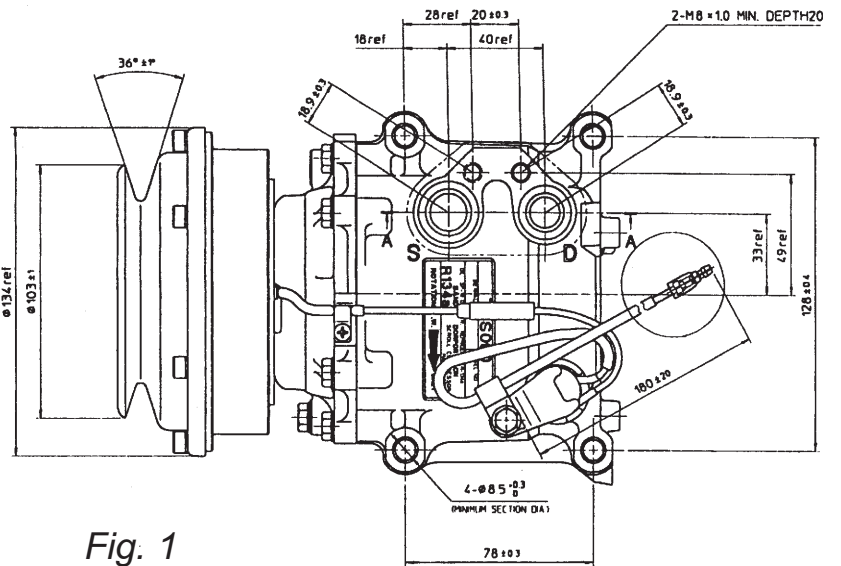
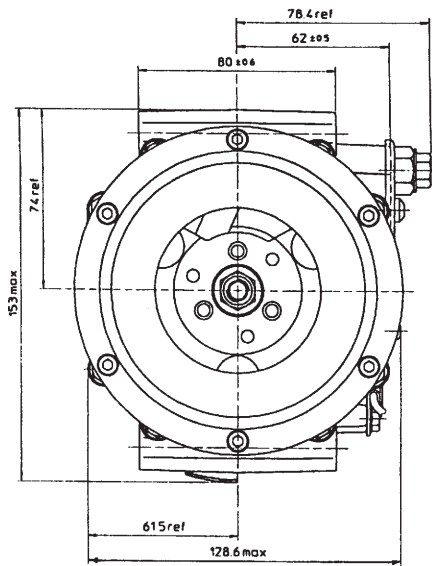

Fig. 1

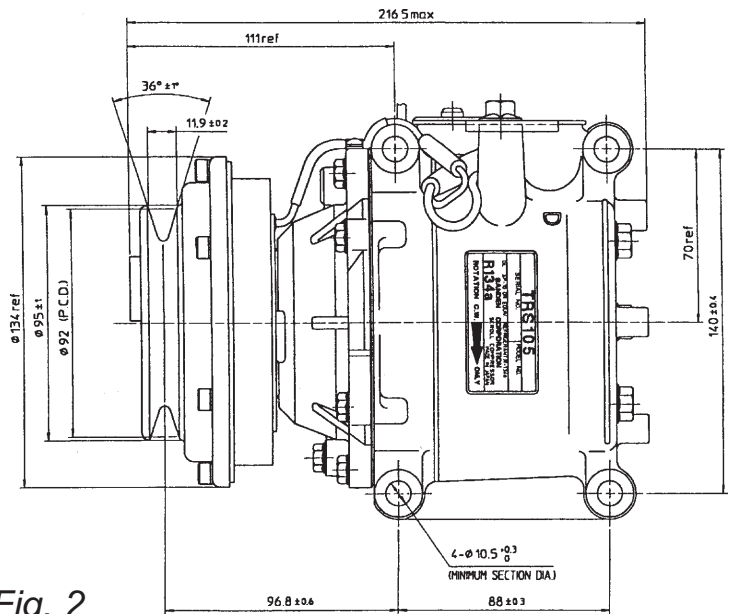
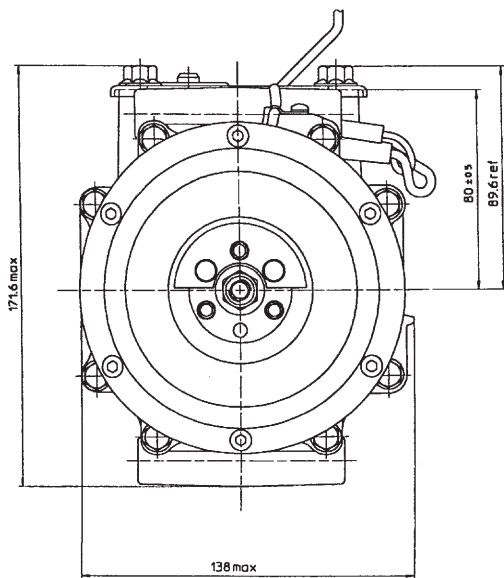

Fig. 2

Fig. Pic.	Codice Autos. Code	Frizione Clutch	Gole Groove	Attacchi Fittings	Misura Size	Volt Volts	Codice originale Original code
1	C.88.07.411.A	Ø103	A1	O	FLANGIA / B.PAD	12V	3019
2	C.88.07.412.A	Ø95	A1	V	FLANGIA / B.PAD	12V	3206



COMPRESSOR

HARRISON
GM

SP 10 aplicação Diavia



Fig. 1



Fig. 2

Fig. Pic.	Codice Autos. Code	Frizione Clutch	Gole Groove	Attacchi Fittings	Misura Size	Volt Volts	Codice originale Original code
1	C.88.16.015.A	ø105	PV6	V	FLANGIA / B.PAD	12V	015142
2	C.88.16.016.A	ø121	A2	V	FLANGIA / B.PAD	12V	015155/2

V 5 applicazione Diavia



Fig. 1



Fig. 2



Fig. 3



Fig. 4



Fig. 5

Fig. Pic.	Codice Autos. Code	Frizione Clutch	Gole Groove	Attacchi Fittings	Misura Size	Volt Volts	Codice originale Original code
1	C.88.16.011.A	ø132	A2	O	ROTOLOCK 1"	12V	15120/1
2	C.88.16.013.A	ø132	A2	V	ROTOLOCK 1"	12V	15122/1
3	C.88.16.012.A	ø118	PV8	O	ROTOLOCK 1"	12V	15121/1
4	C.88.16.014.A	ø118	PV8	V	ROTOLOCK 1"	12V	15123/1
5	C.88.16.123.A	ø118	PV10	O	ROTOLOCK 1"	12V	



COMPRESSOR

HARRISON
GM

Radial 4



Fig. 1

<i>Fig. Pic.</i>	<i>Codice Autos. Code</i>	<i>Frizione Clutch</i>	<i>Gole Groove</i>	<i>Attacchi Fittings</i>	<i>Misura Size</i>	<i>Volt Volts</i>	<i>Codice originale Original code</i>
1	C.88.16.038.A	ø128	A1	O	FLANGIA / B.PAD	12V	

GM A6

BUS



Fig. 1

BUS



Fig. 2

BUS



Fig. 3



Fig. 4



Fig. 5

Fig. Pic.	Codice Autos. Code	Frizione Clutch	Gole Groove	Attacchi Fittings	Misura Size	Volt Volts	Codice originale Original code
1	C.88.16.122.A	ø144	A1	O	FLANGIA / B.PAD	24V	
2	C.88.16.131.A	ø128	A1	O	FLANGIA / B.PAD	24V	
3	C.88.16.132.A	ø128	10.5x2	O	FLANGIA / B.PAD	24V	
4	C.88.16.158.A	ø128	A1	O	FLANGIA / B.PAD	12V	
5	C.88.16.159.A	ø144	A1	O	FLANGIA / B.PAD	12V	



Fig. 1



Fig. 2



Fig. 3

FINE SERIE



Fig. 4

FINE SERIE



Fig. 5

Fig. Pic.	Codice Autos. Code	Frizione Clutch	Gole Groove	Attacchi Fittings	Misura Size	Volt Volts	Codice originale Original code
1	C.88.16.155.A	ø104	9.5x1	V	FLANGIA / B.PAD		SS 48 DL
2	C.88.07.219.A	ø118	9.5x1	V	FLANGIA / B.PAD		SS 10 M2
3	C.88.16.162.A	ø135	A2	V	ROTOLOCK 1"	12V	SS 121 DS3
4	C.88.16.163.A	ø116	A2	V	ROTOLOCK 1"	12V	SS 121 DS3
5	C.88.16.164.A	ø135	A2	V	FLANGIA / B.PAD	12V	SS 170 P

TM 08 HD / HS



Fig. 1



Fig. 2



Fig. 3

Fig. Pic.	Codice Autos. Code	Frizione Clutch	Gole Groove	Attacchi Fittings	Misura Size	Volt Volts	Codice originale Original code
1	C.88.16.120.A	ø123	PV4	V	O.RING 7/8" - 3/4"	12V	488 - 42080
2	C.88.16.157.A	ø135	A2	V	O.RING 7/8" - 3/4"	12V	488 - 42083
3	C.88.16.211.A	ø125	A2	V	O.RING 7/8" - 3/4"	24V	488 - 42015
3	C.88.16.212.A	ø125	A2	V	O.RING 7/8" - 3/4"	12V	488 - 42021

TM 13 HD / HS



Fig. 1



Fig. 2



Fig. 3



Fig. 4

Fig. Pic.	Codice Autos. Code	Frizione Clutch	Gole Groove	Attacchi Fittings	Misura Size	Volt Volts	Codice originale Original code
1	C.88.16.031.A	ø125	A2	O	O.RING 7/8" - 3/4"	12V	488 - 44041
2	C.88.16.032.A	ø135	A2	V	O.RING 7/8" - 3/4"	12V	488 - 44070
3	C.88.16.124.A	ø135	A2	V	O.RING 7/8" - 3/4"	24V	488 - 44074
4	C.88.16.125.A	ø123	PV6	V	O.RING 7/8" - 3/4"	12V	488 - 44038
1	C.88.16.179.A	ø125	A2	O	ROTOLOCK 1"	12V	488 - 44010
2	C.88.16.204.A	ø123	PV8	V	ROTOLOCK 1"	12V	

TM 15 HD / HS



Fig. 1



Fig. 2



Fig. 3



Fig. 4



Fig. 5



Fig. 6

Fig. Pic.	Codice Autos. Code	Frizione Clutch	Gole Groove	Attacchi Fittings	Misura Size	Volt Volts	Codice originale Original code
1	C.88.16.029.A	ø123	PV8	V	O.RING 7/8" - 3/4"	12V	488 - 45120
3	C.88.16.030.A	ø124	A2	V	O.RING 7/8" - 3/4"	12V	488 - 45011
4	C.88.16.036.A	ø135	A2	O	O.RING 7/8" - 3/4"	12V	488 - 45030
5	C.88.16.039.A	ø135	A2	O	FLANGIA / B.PAD	12V	488 - 45210
5	C.88.16.040.A	ø135	A2	O	FLANGIA / B.PAD	24V	488 - 45212
2	C.88.16.046.A	ø123	PV8	O	ROTOLOCK 1"	12V	488 - 45126
6	C.88.16.047.A	ø125	A2	O	ROTOLOCK 1"	12V	
2	C.88.16.048.A	ø123	PV8	O	O.RING 7/8" - 3/4"	24V	
3	C.88.16.128.A	ø135	A2	V	O.RING 7/8" - 3/4"	24V	488 - 45017
2	C.88.16.170.A	ø123	PV8	O	ROTOLOCK 1"	24V	
6	C.88.16.178.A	ø132	A2	O	O.RING 7/8" - 3/4"	24V	488 - 45029
	C.88.16.202.A	ø132	A2	O	ROTOLOCK 1"	24V	
2	C.88.16.205.A	ø123	PV8	O	O.RING 7/8" - 3/4"	12V	488 - 45084
6	C.88.16.213.A		PV6	O	FLANGIA / B.PAD	12V	488 - 45218



COMPRESSOR

ZEXEL - TM

TM 16 HD / HS



Fig. 1



Fig. 2



Fig. 3



Fig. 4

Fig. Pic.	Codice Autos. Code	Frizione Clutch	Gole Groove	Attacchi Fittings	Misura Size	Volt Volts	Codice originale Original code
1	C.88.16.033.A	ø135	A2	V	O.RING 7/8" - 3/4"	12V	488 - 46011
2	C.88.16.034.A	ø135	A2	V	O.RING 7/8" - 3/4"	24V	488 - 46015
3	C.88.16.130.A	ø123	PV8	V	O.RING 7/8" - 3/4"	12V	488 - 46120
4	C.88.16.169.A	ø135	A2	O	O.RING 7/8" - 3/4"	12V	
	C.88.16.175.A	ø135	A2	O	ROTOLOCK 1"	12V	
	C.88.16.176.A	ø135	A2	O	O.RING 7/8" - 3/4"	24V	
	C.88.16.203.A	ø123	PV8	V	O.RING 7/8" - 3/4"	24V	

**TM 15 XD / TM 16 XD R-404a
 Transporte refrigeração**

Fig. 1

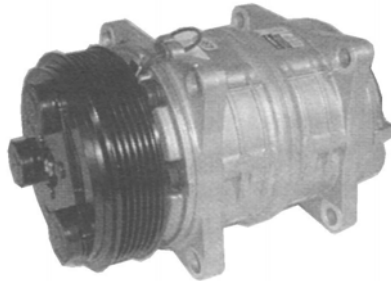

Fig. 2



Fig. 3



Fig. 4



Fig. 5



Fig. 6

Fig. Pic.	Codice Autos. Code	Frizione Clutch	Gole Groove	Attacchi Fittings	Misura Size	Volt Volts	Codice originale Original code
1	C.88.16.241.A	ø135	A2	O	FLANGIA / B.PAD	12V	
2	C.88.16.242.A	ø123	PV8	O	FLANGIA / B.PAD	12V	
3	C.88.16.243.A	ø135	A2	V	O.RING 7/8" - 3/4"	12V	
4	C.88.16.244.A	ø135	A2	V	O.RING 7/8" - 3/4"	24V	
5	C.88.16.245.A	ø123	PV8	O	O.RING 7/8" - 3/4"	12V	
6	C.88.16.246.A	ø135	A2	V	O.RING 7/8" - 3/4"	12V	



COMPRESSOR

ZEXEL - TM

TM 31 HD / TM 21 HX **BUS**



Fig. 1



Fig. 2



Fig. 3

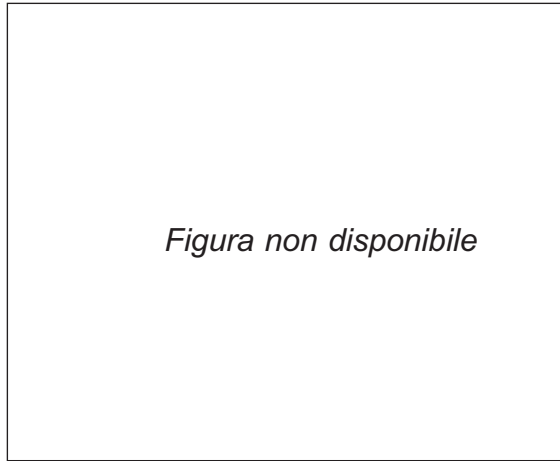

Fig. 4

TM 31 HD							
Fig. Pic.	Codice Autos. Code	Frizione Clutch	Gole Groove	Attacchi Fittings	Misura Size	Volt Volts	Codice originale Original code
1	C.88.16.037.A	ø158	B2 / 17	O	O.RING 7/8" - 3/4"	24V	
2	C.88.16.035.A	ø158	A2 / 12.5	O	O.RING 7/8" - 3/4"	24V	
4	C.88.16.215.A		PV8	O	O.RING 7/8" - 3/4"	24V	
TM 21 HX							
3	C.88.16.171.A	ø141	PV8	O	FLANGIA / B.PAD	24V	
3	C.88.16.172.A	ø145	A2 / 12.5	O	FLANGIA / B.PAD	24V	
3	C.88.16.173.A	ø145	A2 / 12.5	O	FLANGIA / B.PAD	12V	
3	C.88.16.174.A	ø141	PV8	O	FLANGIA / B.PAD	12V	

206 / 209 / 210

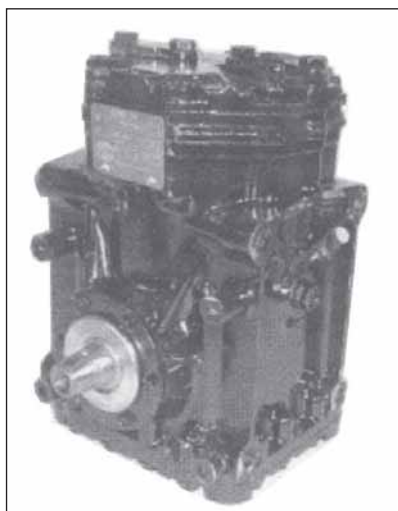

Fig. 1

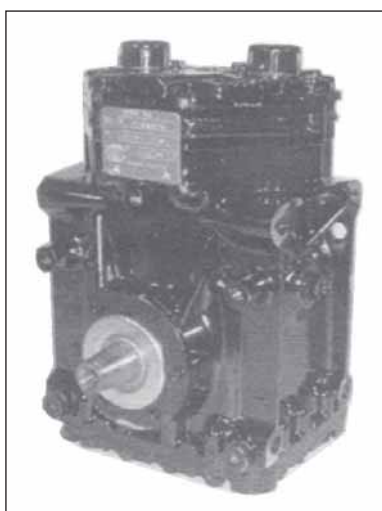

Fig. 2

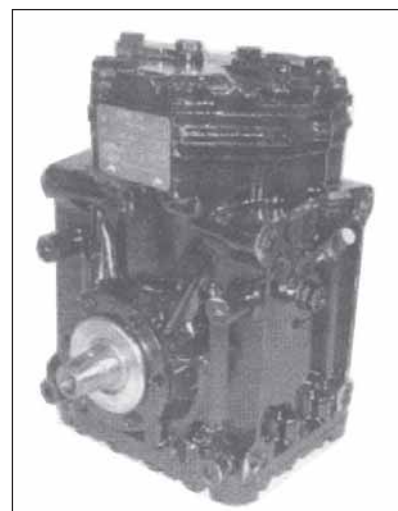

Fig. 3

Fig. Pic.	Codice Autos. Code	Frizione Clutch	Gole Groove	Attacchi Fittings	Misura Size	Codice originale Original code
1	C.88.16.041.A	/	/	V	FLANGIA asp.dx / B.PAD	F 210R
2	C.88.16.160.A	/	/	V	ROTOLOCK asp.dx	R 210R
3	C.88.16.161.A	/	/	V	FLANGIA asp.dx / B.PAD	F 209R
1	C.88.16.177.A	/	/	V	FLANGIA asp.dx / B.PAD	F 206R